

PENETRATOR

MOBILE FALL PROTECTION

*Patent Pending

The industries' first lightweight and fully portable mobile fall protection device

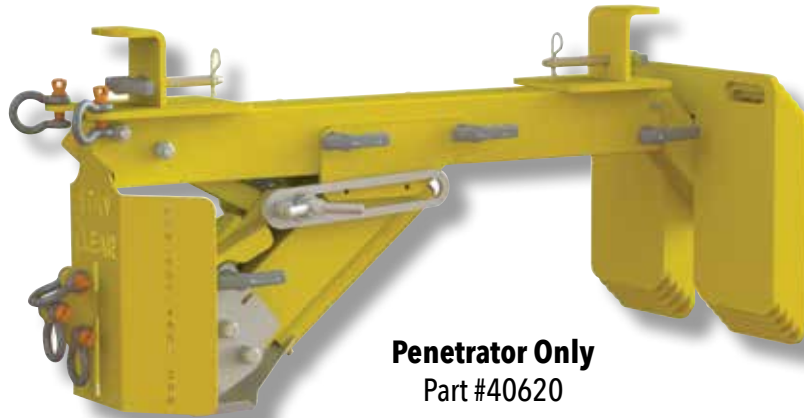

Penetrator Only
Part #40620

When a fall occurs, the powerful penetrating spikes engage, piercing into the roof insulation and metal decking, thus creating a safe, secure anchor. For use on most substrates, EXCLUDING concrete, the Penetrator has been tested for use on Built-Up, TPO, ISO, PVC, EPDM, and other standard materials that are part of a finished roof system. The Penetrator is reusable and offers the lightest mobile fall protection system available on the market today. Gross weight of Penetrator, ballasts and cart is 515 lbs.

The Penetrator provides fall protection for 3 fall arrest and 2 fall restraint or a total of 5 workers

The Penetrator is compliant with OSHA Fall Protection Regulation 1926.502

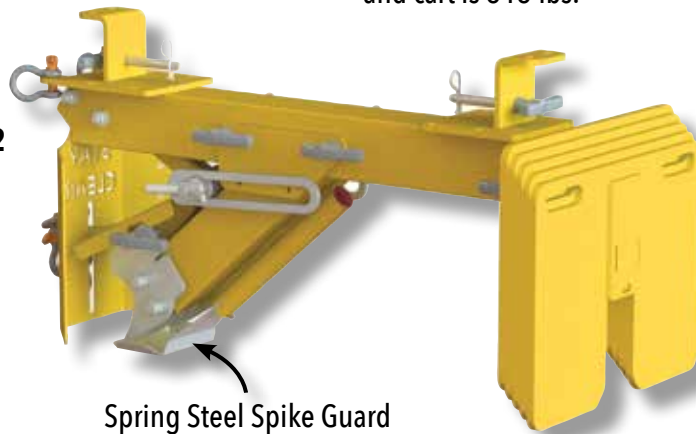

Spring Steel Spike Guard



2 Fall Restraint Attachment Points

Simple 2 Pin Installation

3 Fall Arrest Attachment Points

Telescoping Arm Extends and Supports Ballast

3 Engagement Spikes

5 - 30 lb. Ballast Weights Included

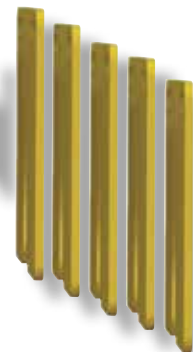

Complete Penetrator with Cart

Features locking steering column, flat free tires, while providing mobile fall protection, in addition to accommodating up to 2000 lbs. of materials (gross weight).

**Penetrator Fall Protection
and Roof Zone Cart**
Part #65033



Roof Zone Cart

For use with the movements of felt, tear off debris, deck materials along with other roofing material. Features an 11 gage steel tube, 30" wide frame, 72" overall length, 2,000 lbs. capacity, 18" heavy-duty flat free tires, dead-man brake, anti turning pin and additional accessories as shown below.

Roof Zone Cart

Model #65028

Replacement Flat Free Tires (one tire)

Part #65019

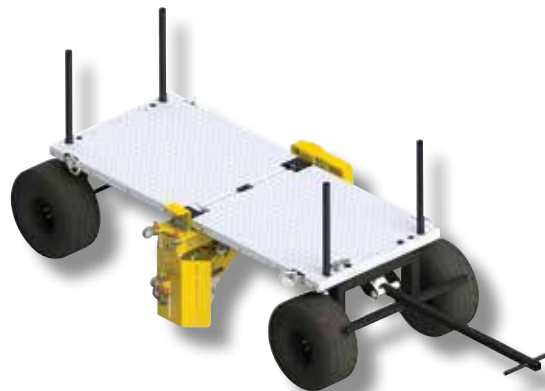

Roof Zone Cart Accessories



Towing Clevis
Part #65029

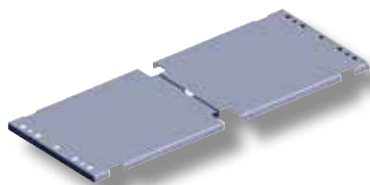

**Aluminum Tread
Brite Decking**
Part #65031

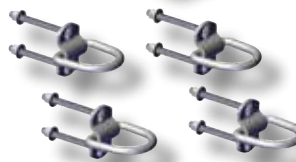

Hoisting Rings
Part #65032



**Rolled Goods
Attachment Post**
Part #65030